

Soils Map

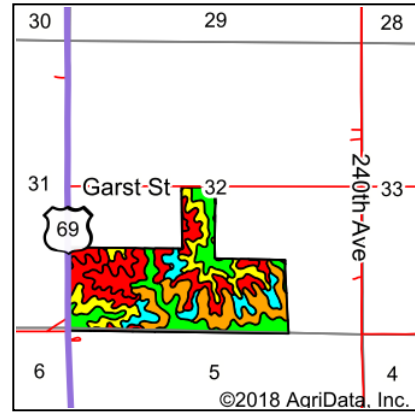

State: **Iowa**
 County: **Clarke**
 Location: **32-72N-25W**
 Township: **Osceola**
 Acres: **148**
 Date: **9/4/2018**

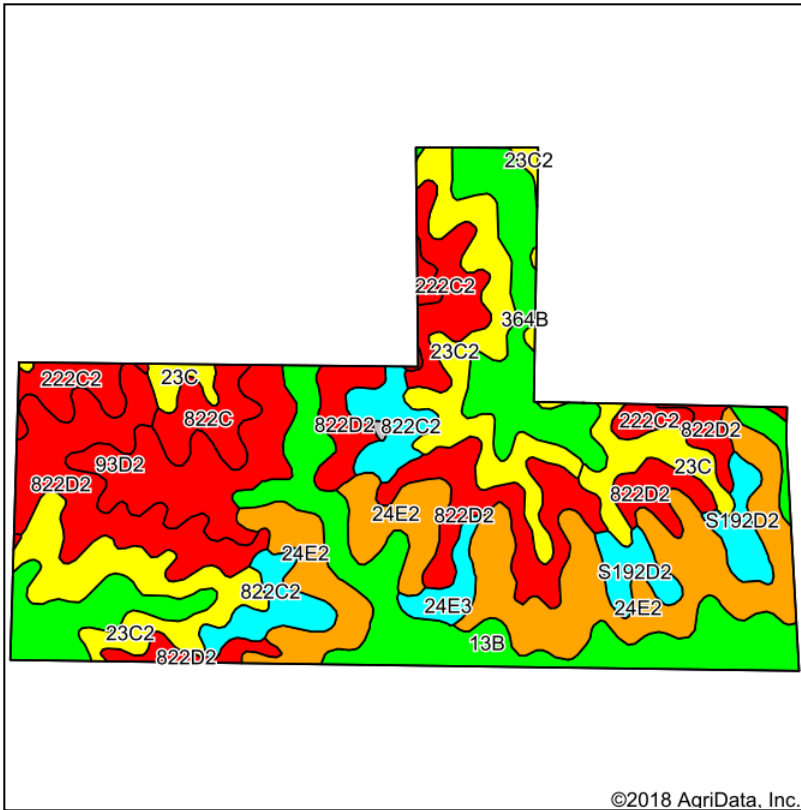

Soils data provided by USDA and NRCS.

Area Symbol: IA039, Soil Area Version: 23

Code	Soil Description	Acres	Percent of field	CSR2 Legend	Non-Irr Class *c	*i Corn	*i Soybeans	CSR2**	CSR	NCCPI Soybeans	
822D2	Lamoni clay loam, 9 to 14 percent slopes, moderately eroded	27.95	18.9%		IVe	100.8	29.2	30	15	42	
24E2	Shelby clay loam, 14 to 18 percent slopes, moderately eroded	27.03	18.3%		IVe	144	41.8	40	33	47	
23C2	Arispe silty clay loam, 5 to 9 percent slopes, moderately eroded	19.49	13.2%		IIIe	80	23.2	62	50	73	
13B	Olmitz-Zook-Colo complex, 0 to 5 percent slopes	18.29	12.4%		IIw	192	55.7	77	60	73	
364B	Grundy silty clay loam, 2 to 5 percent slopes	15.11	10.2%		Ile	80	23.2	72	75	69	
93D2	Shelby-Adair complex, 9 to 14 percent slopes, moderately eroded	9.45	6.4%		IVe	139.2	40.4	34	25	46	
222C2	Clarinda silty clay loam, 5 to 9 percent slopes, moderately eroded	8.50	5.7%		IVw	140.8	40.8	34	25	38	
822C2	Lamoni clay loam, 5 to 9 percent slopes, moderately eroded	6.45	4.4%		IIIe	129.6	37.6	29	30	50	
23C	Arispe silty clay loam, 5 to 9 percent slopes	5.23	3.5%		IIIe	80	23.2	66	55	75	
S192D2	Adair clay loam, heavy till, 9 to 14 percent slopes, moderately eroded	4.78	3.2%		IVe	0	0	24		41	
822C	Lamoni clay loam, 5 to 9 percent slopes	3.65	2.5%		IIIe	134.4	39	39	35	52	
24E3	Shelby clay loam, 14 to 18 percent slopes, severely eroded	1.95	1.3%		Vle	132.8	38.5	27	30	34	
**IA has updated the CSR values for each county to CSR2.											
*- CSR weighted average cannot be calculated on the current soils data, use prior data version for csr values.											
W _i Yield data provided by the ISPAID Database version 8.10.12 developed by IA State University.											
*c: Using Capabilities Class Dominant Condition Aggregation Method											
Weighted Average						118.3	34.3	47.8	*-	55.2	

Soils data provided by USDA and NRCS.