

# Soils Map

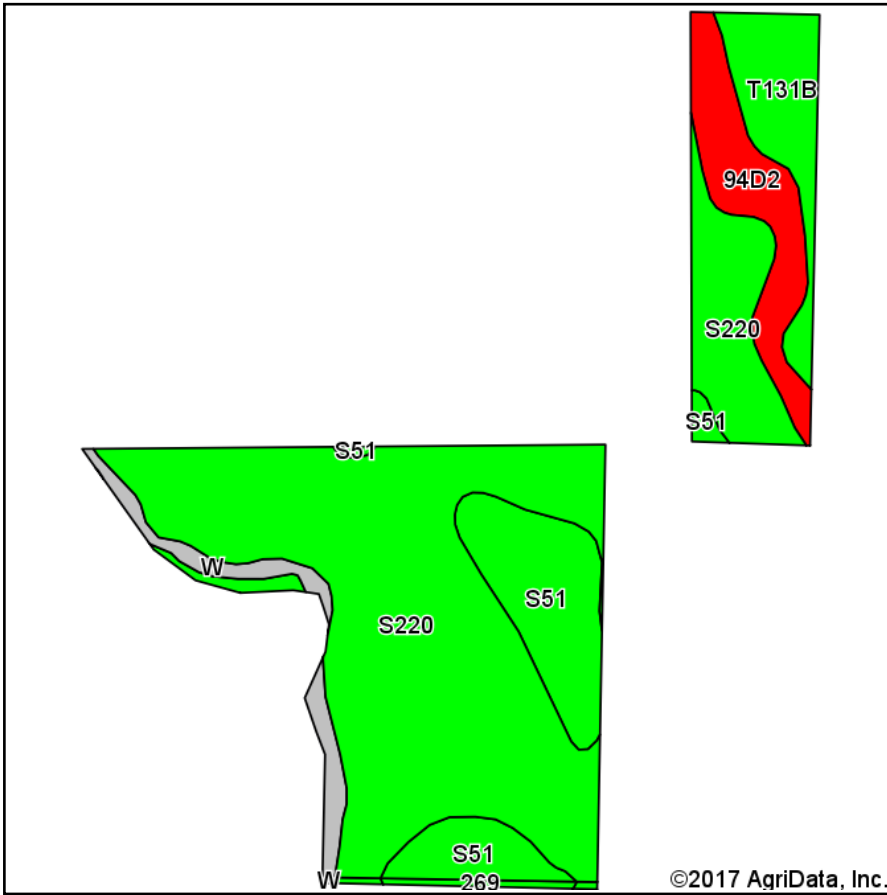

Soils data provided by USDA and NRCS.

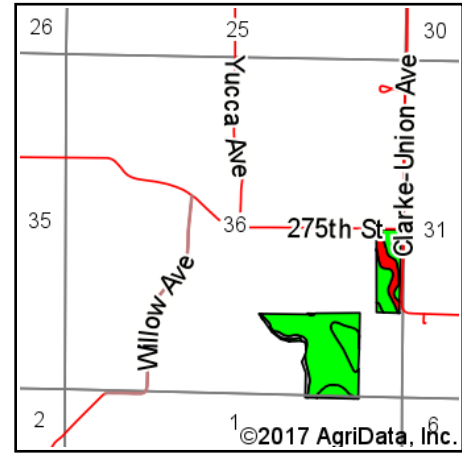

State: **Iowa**  
 County: **Union**  
 Location: **36-71N-28W**  
 Township: **Pleasant**  
 Acres: **42**  
 Date: **5/23/2017**

Maps Provided By:  
  
 CUSTOMIZED ONLINE MAPPING  
 © AgriData, Inc. 2017 [www.AgrIDataInc.com](http://www.AgrIDataInc.com)



Area Symbol: IA159, Soil Area Version: 21  
 Area Symbol: IA175, Soil Area Version: 18

Code	Soil Description	Acres	Percent of field	CSR2 Legend	Non-Irr Class *c	*i Corn	*i Soybeans	CSR2**	CSR
S220	Nodaway silt loam, heavy till, 0 to 2 percent slopes	26.59	63.3%		IIw			77	
S51	Vesser silt loam, 0 to 2 percent slopes, occasionally flooded	6.29	15.0%		IIw			75	
94D2	Mystic-Caleb complex, 9 to 14 percent slopes, moderately eroded	3.80	9.0%		IVe	120	34.8	30	21
T131B	Pershing silt loam, terrace, 2 to 5 percent slopes	3.25	7.7%		IIIe	163.2	47.3	71	65
W	Water	1.72	4.1%			0	0	0	0
269	Humeston silty clay loam, 0 to 2 percent slopes, occasionally flooded	0.26	0.6%		IIIw	179.2	52	70	58
S220	Nodaway silt loam, heavy till, 0 to 2 percent slopes	0.09	0.2%		IIw			77	
<b>Weighted Average</b>						<b>24.6</b>	<b>7.1</b>	<b>68.8</b>	<b>*-</b>

\*\*IA has updated the CSR values for each county to CSR2.

\*- CSR weighted average cannot be calculated on the current soils data, use prior data version for csr values.

\*i Yield data provided by the ISPAID Database version 8.1 developed by IA State University.

\*c: Using Capabilities Class Dominant Condition Aggregation Method

Soils data provided by USDA and NRCS.